

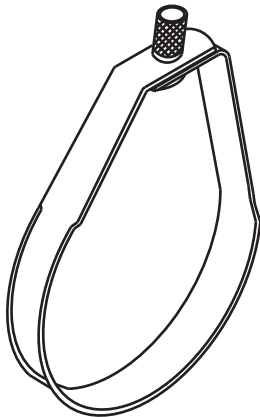

P.O. Box 3365 South El Monte, CA 91733 626.444.0541 Fax 626.444.3887 www.Afcon.org

### 300

## RING HANGER



3/4 thru 4 inch pipe  
LISTED FOR STEEL/CPVC



1/2 inch pipe  
5 thru 8 inch pipe

NFPA 13		MAX REC.	METRIC
PIPE	ROD	LOAD LBS.	REFERENCE
3/4	3/8	400	20
1	3/8	400	25
1 1/4	3/8	400	32
1 1/2	3/8	400	40
2	3/8	400	50
2 1/2	3/8	600	65
3	3/8	600	80
3 1/2	3/8	600	
4	3/8	1000	100
5	1/2	1250	125
6	1/2	1250	150
8	1/2	1250	200

**SIZE** - 1/2 thru 8 inch pipe.

**MATERIAL** - Carbon Steel, Mil. Galvanized to G-90 spec.

**LISTING/APPROVAL** -

**203-EX 2551**

**Approval guide - Pipe Hangers**

**OSHPD** OPA-0601 See Website.

**CONFORMS WITH:** Federal Specification WW-H-171 Type 10,  
Manufacturers Standardization Society ANSI/MSS-SP-58 Type 10.

**MAXIMUM TEMPERATURE** - 650°F.

**FUNCTION** - Pipe hanger component for use on steel, CPVC or copper piping.

**INSTALLATION** - Per NFPA 13, 13R, 13D and CPVC manufacturers instructions.

**SPECIAL NOTE:** When installing on CPVC sprinkler system pipe:

Verify that all assembly components are cleaned of any surface oil.

**FEATURES** -

- \* Sized and listed exclusively for use with #310 Surge Restrainer.
- \* Band edge is offset for EASY pipe insertion.
- \* Custom fit swivel nut for better retention in ring body.
- \* Full length knurl on swivel nut for better grip.

**ORDERING** - Part #, pipe size.

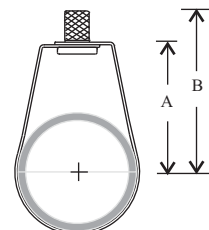

PIPE	A	B
1	1.8793	2.5259
1 1/4	2.1382	2.7850
1 1/2	2.2673	2.9140
2	2.6048	3.2516
2 1/2	3.4920	4.1150
3	3.7845	4.4311
4	4.3582	4.9992
6	6.0668	6.8180
8	7.5768	8.3290

