

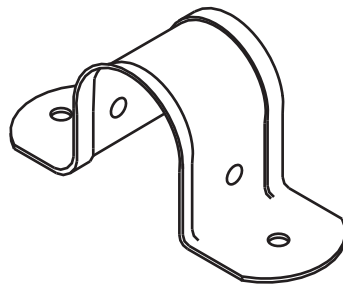

P.O. Box 3365 South El Monte, CA 91733 626.444.0541 Fax 626.444.3887 www.Afcon.org

# 510

## CPVC - STEEL - COPPER HANGER



510 SIZE	Fastener Dim. Q - Q <sub>1</sub>
3/4	2.125
1	2.312
1 1/4	3.170
1 1/2	3.400
2	4.010
2 1/2	4.320
3	5.320

**SIZE** - 3/4" thru 3" pipe - see Function.

**MATERIAL** - Carbon Steel.

**FINISH** - Mil. Galvanized.

**LISTING/APPROVAL** -



**FUNCTION** - To support horizontal piping 3/4" -2" CPVC, Copper or Steel.

To support horizontal piping 2 1/2" -3" CPVC and Copper.

Hanger in listed mounting positions - Top, Bottom or Side.

Also, provides stability on vertical piping.

**INSTALLATION** - Per NFPA 13, 13R, 13D and CPVC manufacturers instructions, mount on top, bottom or side of building element. Space by pipe type.

**FASTENERS** - UL Listed per NFPA 13

in **WOOD**:

3/4" - 3" CPVC pipe - #905 screw - no pre-drill.

3/4" - 2" Steel and Copper pipe - 1/4"x1 1/2" lag screw - no pre-drill.

in **STEEL** - min. 18 GA.

3/4" - 3" CPVC pipe - 1/4" or #14 Tek Screw.

3/4" - 2" Steel and Copper pipe - 1/4" or #14 Tek Screw.

### FEATURES

\* Offset edge eliminates abrasion.

\* Retainer dimples secure hanger to pipe during installation.

\* Required AFCON #905 screw has 5/16" hex head - included.

**ORDERING** - Part # and pipe size.

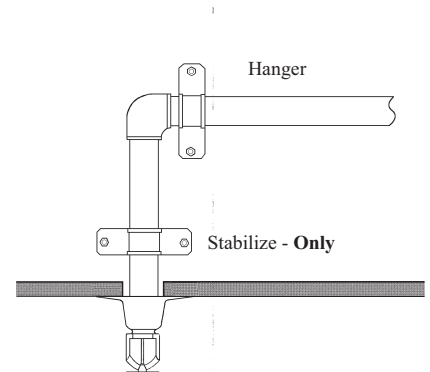

**\*CAN ALSO BE USED TO REPLACE - #500 Pipe Strap  
#520 Tin Strap**

Specific AFCON products are exclusively designed to be compatible ONLY with other AFCON products including parts and fasteners, resulting in a listed sway brace, restrainer or hanger assembly. Be advised the following warranty restriction will apply. **DISCLAIMER** - AFCON will NOT warrant against the failure of its products when used in combination with other products, parts or systems not manufactured or sold by AFCON. AFCON shall NOT be liable under any circumstances whatsoever for any direct or indirect, incidental or consequential damages of any kind, including but not limited to loss of business or profit, when non-AFCON products have been, or are used.

