

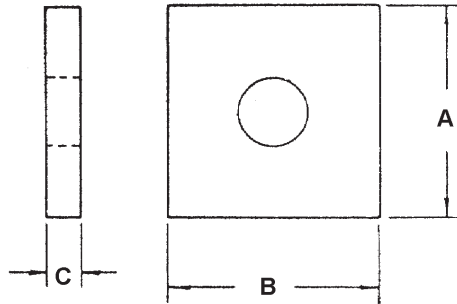

P.O. Box 3365 South El Monte, CA 91733 626.444.0541 Fax 626.444.3887 www.Afcon.org

**856**

**CUSTOM  
PLATE WASHER**



ROD SIZE	BORE DIA
3/8	7/16
1/2	9/16
5/8	11/16
3/4	13/16

\*Bore Dia. = Rod Dia. + 1/16" per NFPA 13

**SIZE** - 3/8 thru 3/4 inch rod.  
**MATERIAL** - Carbon Steel.  
**FINISH** -Plain, E.G.  
**FUNCTION** - Various.  
**NOTE** - Made to order customer specify A, B and C dimension.  
**ORDERING** - Part # and finish.

