



P.O. Box 3365 South El Monte, CA 91733 626.444.0541 Fax 626.444.3887 www.Afcon.org

535

## EYESOCKET OFFSET

**SIZE** - 3/8" rod

**MATERIAL** - Carbon Steel.

**FINISH** - Plain or E.G.

**LISTING/APPROVAL** -

 **203 - EX 2551**

**FUNCTION** -Listed to support max. 4" Steel, CPVC or Copper pipe.

Listed hanger component per NFPA 13.

Substitute for an eye rod.

**INSTALLATION** - per NFPA 13. Space by pipe type.

Install on vertical mounting surface of wood, concrete or steel.

Center hole accepts 3/8" and 1/2" NFPA 13 fasteners.

**ADDITIONAL UL LISTED FASTENERS PER NFPA 13 FOR STEEL PIPE LOADS -SEE TABLES..**

### FEATURES

- \* Heaviest material thickness in the industry.
- \* Tapped threads, assures proper rod fit.
- \* Offset design allows rod to hang straight.
- \* **No speed/pal nuts** required.
- \* **Caution** - Many eyesockets have embossed threads in thin metal.  
Beware of loose thread fit and potential for pull out.

**ORDERING** - Part # and finish.

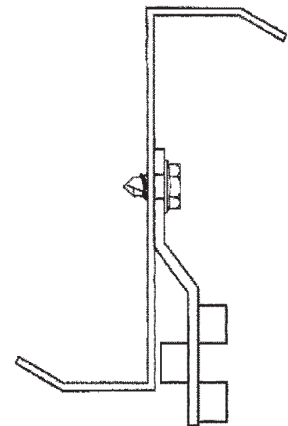
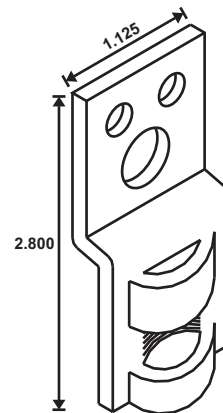

UL FASTENER TABLE					
Wood - No Pre Drill			Steel - 1/4" or #14 Tek		
Fastener	Qty.	Pipe Size	Thickness	Qty.	Pipe Size
#14x1 1/2 S.M.S.	2	2	14 GA.	2	4
#14x2 S.M.S.	2	4			
1/4 x 2 Lag Bolt	2	4	16 GA.	2	3
#16x2 D.S.	2	2	18 GA.	2	2 1/2

