



P.O. Box 3365 South El Monte, CA 91733 626.444.0541 Fax 626.444.3887 www.Afcon.org

550

**REVOLVER™
SWIVEL**

SIZE - ROD: 3/8"
SIZE - SYSTEM PIPE: 4" max.
MATERIAL - Carbon Steel or S.S. (Type 304).
FINISH - Mil. Galvanized.
LISTING/APPROVAL -



PATENT - No. 6,568,642
FUNCTION - Attachment component of an *AFCON* hanger.
 To support horizontal piping.
INSTALLATION - Per NFPA 13 and these instructions.
 Install on vertical or horizontal mounting surface.
ASSEMBLY/ATTACHMENT - See drawing.
 Center mounting hole accepts 3/8" and 1/2" fasteners.

SPECIAL **FASTENERS PER NFPA 13
FOR STEEL PIPE - SEE TABLES.**

TABLE A - Vertical Mounting
TABLE B - Horizontal Mounting

FEATURES

- * Universal fastener array for enhanced mounting.
- * Deep tapped rod bore improves hanger adjustment.
- * No backing nuts required.

ORDERING - Part # and finish.

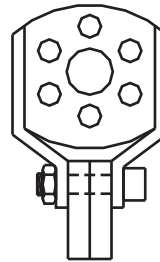
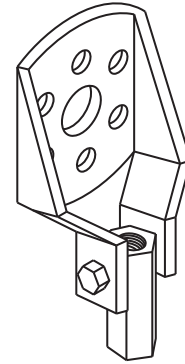

Table A MOUNTING FASTENERS				
Wood		Steel - 1/4 or #14 Tek		
Fastener	Qty.	Steel Pipe	Min. Thickness	Qty. Steel Pipe
1/4 x 1 1/2 LS	1	2	14 GA.	1 3
	2	4		2 4
#14 x 1 1/2 SMS	1	2	16 GA.	1 2 1/2
	2	4		2 4
Wood - Thru 5/8" Gyp.			18 GA.	1 2 1/2
1/4 x 2 LS	1	2		2 3
	2	4		3 4
#14 x 2 SMS	1	2		
	2	4		

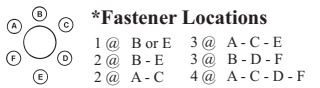

Table B MOUNTING FASTENERS				
Wood		Steel - 1/4 or #14 Tek		
Fastener	Qty.	Steel Pipe	Min. Thickness	Qty. Steel Pipe
1/4 x 2 LS	2	4	1/4	1 2
#14 x 2 SMS	2	4	1/4	2 4

