

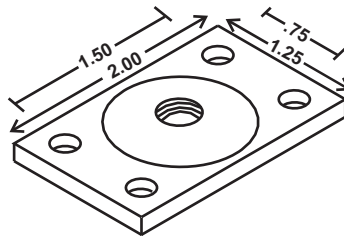

P.O. Box 3365 South El Monte, CA 91733 626.444.0541 Fax 626.444.3887 www.Afcon.org

610

CEILING PLATE



SIZE - ROD - 3/8"
SIZE - SYSTEM PIPE - 4"
MATERIAL - Carbon Steel.
FINISH - Plain, E.G. and S.S.
LISTINGS -



FUNCTION - Attachment component of an *AFCON* hanger.
INSTALLATION - Per NFPA 13 and these instructions.
 Install on horizontal mounting surface - may also be welded.

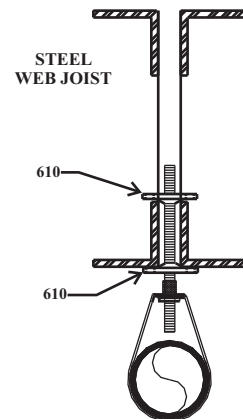

Special fasteners - see chart

UL Fastener Locations	
Ⓐ	Ⓑ
Ⓒ	Ⓓ
2 @ A - C or B - D	

FEATURES

- * Enhanced mounting ability.
 - * Offset allows 3/16" rod thread through.
 - * Self centers in the joist web - See drawing.
- ORDERING -** Part # and finish.

UL LISTED FASTENERS PER NFPA 13					
Wood			Steel - 1/4 or #14 Tek		
Fastener - No Pre Drill	Qty.	Steel Pipe	Min. Thickness	Qty.	Steel Pipe
1/4 x 1 1/2 Lag	2	3	14 GA.	2	4
	4	4	16 GA.	2	2
#14 x 1 1/2 SMS	2	3		4	4
	4	4			
Wood - Thru 5/8 Gyp.			Steel - #10 SMS or #905		
1/4 x 2 Lag	2	2	18 GA.	4	2 1/2
	4	4	20 GA.	4	2 1/2
#14 x 2 SMS	2	2	22 GA.	4	2
	4	4			

SMS = Sheet Metal Screw
 Lag= Lag Bolt
 Gyp= Gypsum Board

