

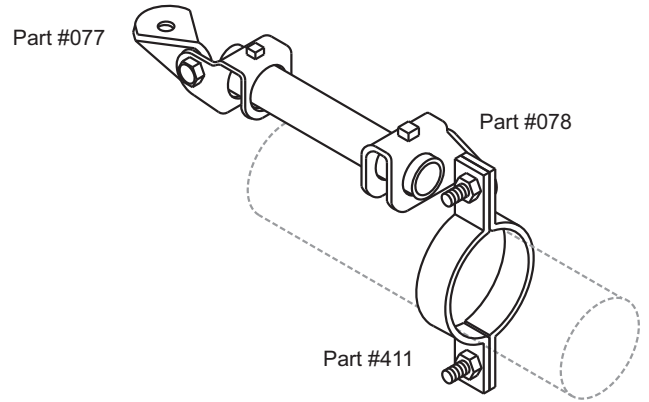

P.O. Box 3365 South El Monte, CA 91733 626.444.0541 Fax 626.444.3887 www.Afcon.org

078

**ATTACHMENT FITTING
LOCKING**

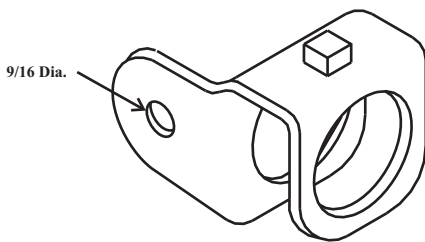

SIZE - BRACE PIPE: 1" and 1 1/4" Sch. 40
MATERIAL - Carbon Steel or S.S. (Type 304).
FINISH - Plain or E.G.
LISTING/APPROVAL -

203A-EX 2625 FM Approved - 1950 OSHPD See Website.

FUNCTION - Structure attachment fitting of an AFCON sway brace assembly.
Common transition component with 411 sway brace fitting - see drawing

INSTALLATION - Per these instructions including NFPA 13 or FM 2-8.

Load rating - see chart.

DO NOT BEND - If angle required use part 070, 075, 076 or 077.

ASSEMBLY

Combine with proper AFCON components- see disclaimer below.

Insert brace pipe thru fitting near pivot bolt.

Tighten set bolt until head contacts bracket.

FEATURES

* Visual inspection, verifies proper installation.

* Bolt hole fits 411 sway brace fitting.

ORDERING - Part #, size - brace pipe and finish.

Max. Horizontal Load	
30° thru 90°	2015

Max. ASD Horizontal Load			
30°-44°	45°-59°	60°-74°	75°-90°
430	620	760	940

Specific AFCON products are exclusively designed to be compatible ONLY with other AFCON products including parts and fasteners, resulting in a listed sway brace, restrainer or hanger assembly. Be advised the following warranty restriction will apply. **DISCLAIMER - AFCON will NOT warrant against the failure of its products when used in combination with other products, parts or systems not manufactured or sold by AFCON. AFCON shall NOT be liable under any circumstances whatsoever for any direct or indirect, incidental or consequential damages of any kind, including but not limited to loss of business or profit, when non-AFCON products have been, or are used.**

