

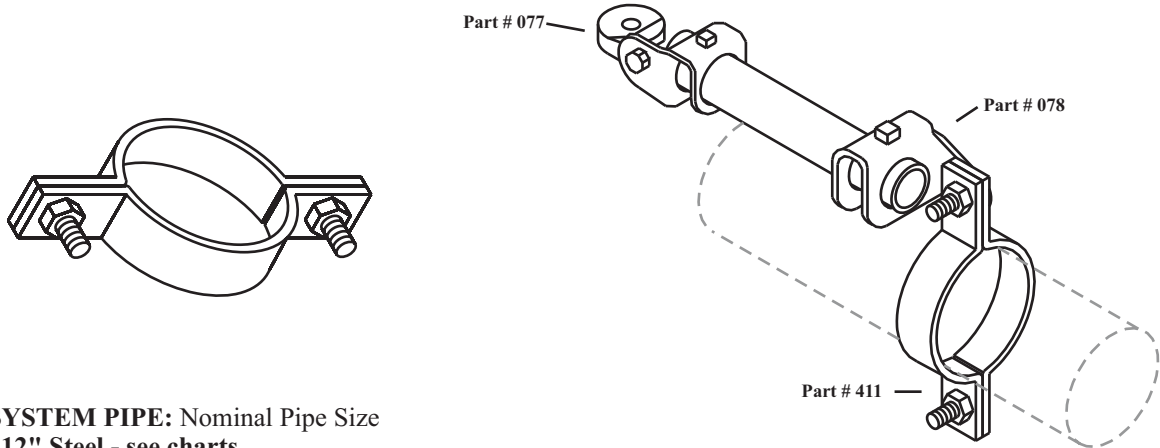

P.O. Box 3365 South El Monte, CA 91733 626.444.0541 Fax 626.444.3887 www.Afcon.org

411

SWAY BRACE FITTING



SIZE - SYSTEM PIPE: Nominal Pipe Size

1" - 12" Steel - see charts

MATERIAL - Carbon Steel

FINISH - Plain or E.G.

PATENT - No. 7,140,579

LISTING/APPROVAL

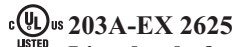

Listed only for use with *AFCON* products.



OSHPD OPA-0601 See Website.

FUNCTION - Longitudinal fitting of an AFCON sway brace assembly.

INSTALLATION - Per NFPA 13 and these instructions.

Load rating - see chart.

Align brace pipe parallel to system pipe.

ASSEMBLY - See drawing.

Combine with proper *AFCON* components.

Engage fastener flanges and torque bolts to 40 ft. lbs.

Horizontal Load Ratings		
Size	UL	FM
1" - 8"	2765	2700
10"	2765	---
12"	3740	---

System Pipe	
Size	UL
1" - 12"	Sch. 40 Steel
1 1/4" - 12"	Sch. 10 Steel
Size	FM
1" - 8"	Sch. 40 Steel
1" - 8"	Sch. 10 Steel
1" - 8"	Lt. Wall Steel

FEATURES

- * **Patented** - design eliminates bending of ears during installation.
- * **Patented** - design prevents over tightening on system pipe.
- * **Improved assembly** - ears connected for superior strength.
- * Visual inspection - proper installation when fastener flanges together.

ORDERING - Part #, pipe size and finish.

Specific *AFCON* products are exclusively designed to be compatible **ONLY** with other *AFCON* products including parts and fasteners, resulting in a listed sway brace, restrainer or hanger assembly. **Be advised** the following warranty restriction will apply. **DISCLAIMER** - *AFCON* will **NOT** warrant against the failure of its products when used in combination with other products, parts or systems not manufactured or sold by *AFCON*. *AFCON* shall **NOT** be liable under any circumstances whatsoever for any direct or indirect, incidental or consequential damages of any kind, including but not limited to loss of business or profit, when non-*AFCON* products have been, or are used.

