

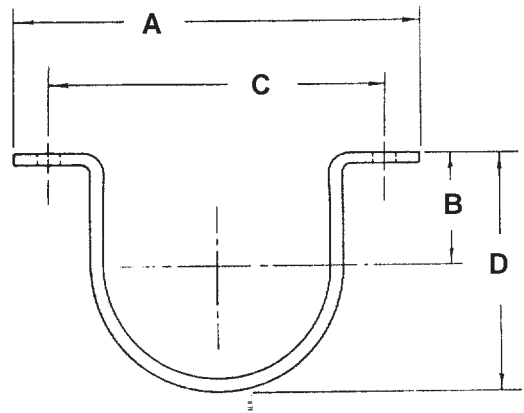

P.O. Box 3365 South El Monte, CA 91733 626.444.0541 Fax 626.444.3887 www.Afcon.org

500

PIPE STRAP STANDARD

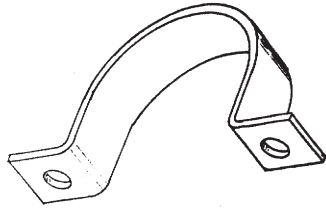

SIZE - 2 1/2 thru 8 inch pipe.
MATERIAL - Carbon Steel.
FINISH - Plain, E.G., H.D.G. and S.S.
LISTING - Conforms to Federal Specification WW-H-171E, type 26, and Manufacturers Standardization Society SP-69, type 26.
FUNCTION - General piping support or hold down.
ORDERING - Part #, pipe size and finish.

PIPE SIZE	A	B	C	D	HOLE SIZE	STOCK SIZE	MAX. REC. LOAD LBS.
3/4"	Not available. Use part # 510 UL Listed per NFPA 13 steel pipe - 3/4" thru 2".						
1"							
1 1/4"							
1 1/2"							
2"							
2 1/2"	6 1/4"	1 11/16"	5 1/4"	3 1/8"	7/16	1/4"X1 1/4"	610
3"	6 7/8"	2"	5 7/8"	3 3/4"	7/16	1/4"X1 1/4"	610
3 1/2"	7 3/8"	2 1/4"	6 3/8"	4 1/4"	7/16	1/4"X1 1/4"	610
4"	8 3/8"	2 1/2"	7"	4 3/4"	9/16	1/4"X1 1/2"	725
5"	9 7/16"	3 1/16"	7 7/8"	5 13/16"	9/16	1/4"X1 1/2"	725
6"	10 1/2"	3 5/8"	8 7/8"	6 7/8"	9/16	1/4"X1 1/2"	725
8"	14"	4 3/8"	11 1/2"	9"	11/16	3/8"X1 1/2"	900

